



GRAND RELIC STUPA

NEW DELHI



Buddhism can be a medium for enhancing one's awareness of life, controlling one's thoughts and behaviors, and living in peace with oneself. The grand relic stupa, the interpretation center, and the zen gardens encapsulate the fundamental pillars of Buddhist teachings, keeping spirituality at the core. The site is surrounded by centers like the lotus Temple, Kalkaji Temple, and Iskcon Temple, forming a spiritual triangle between Hinduism, Buddhism, and Baha'i. The stupa's structure is influenced by the early stages of its construction techniques, which showed a plain earthen mound as a holy icon to encourage hopes and efforts in the search for enlightenment. The stupa is surrounded by a meditation spectrum on one side and a lotus pond on the other around the parikrama path. The interpretation center is camouflaged with a green roof dome that merges with the natural forest cover. It includes a 360-degree immersive experience, an amphitheater, and a museum. Whichever culture brings a stupa to life, its purpose is to provide a sacred space for people to center themselves on higher thoughts and revitalize themselves spiritually.



Mail : info@csrd.foundation
Mob: +91 98254 12694 Ojas Hirani | +91 98796 33377 Hitesh Trivedi

SITE LOCATION

The site is in South East Delhi, near the Lotus Temple, ISKCON Temple, and Nehru Place. A lush green lawn, flowering bushes, and green trees surround the Aastha Kunj park. The site is significant because of the Ashokan Edicts, a collection of preaching on Buddha's teachings written by Ashoka. Moreover, the park appears to have a steady stream of Buddhist pilgrims visiting the place; therefore, it became a significant nucleus to be created in such an elegant demeanor. The nearest metro stations are Kalka Ji Mandir metro station (8.2 KM) and Nehru Place metro station (8.7 KM)



Mantra



Meditation



Vegetarianism



AREA PROGRAM

Stupa
Meditation area
Lower Parikrama
Upper Parikrama
Relic Stupa
Torana
Water Feature
Lotus Pond

Interpretation Centre
Immersive experience area
Amphitheatre
Interpretation centre & Museum

Zen Garden



Birth of Gautham Buddha



Great Departure



Buddha Enlightenment



First Sermon



Maha Pari Nirvana



Site Plan

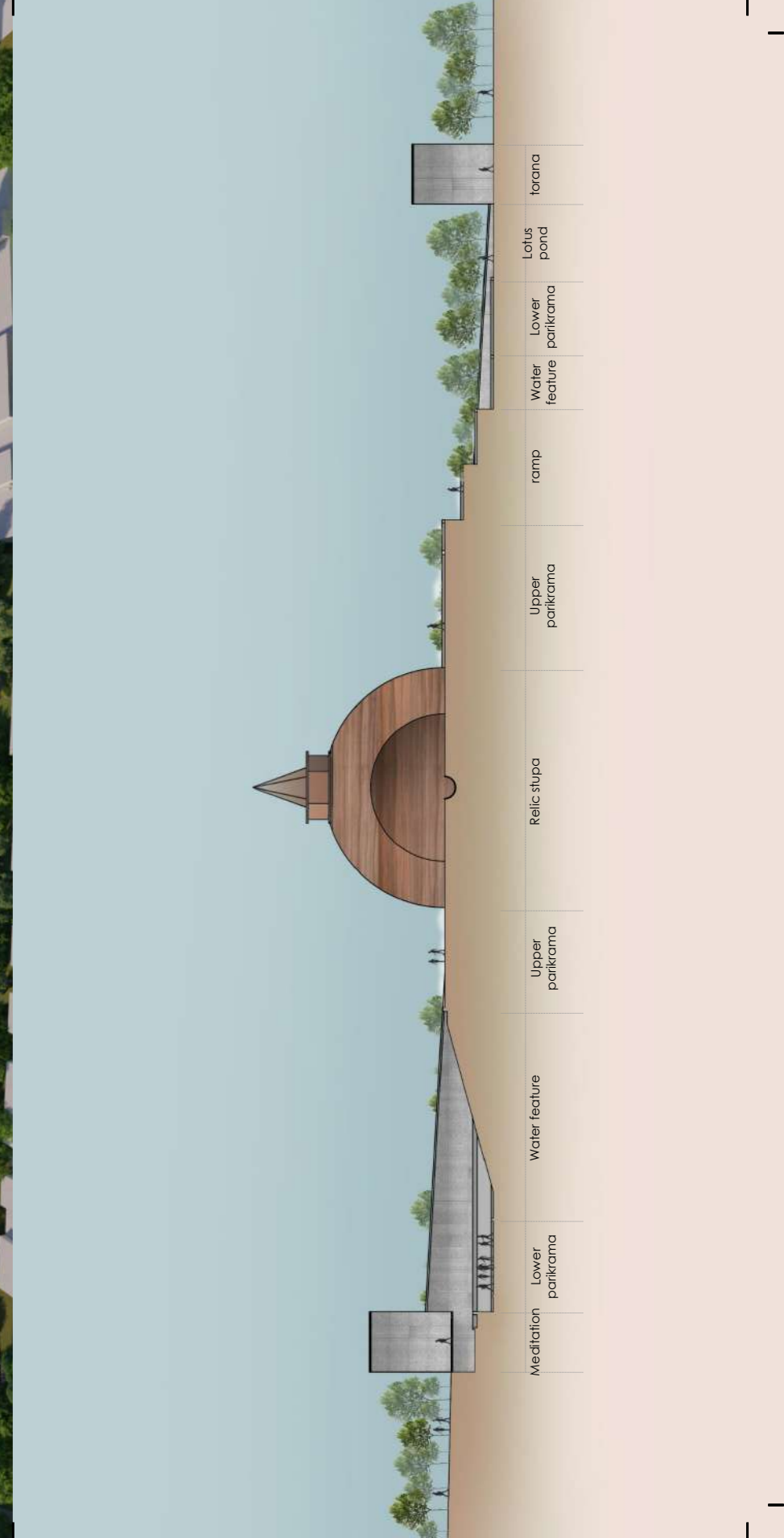
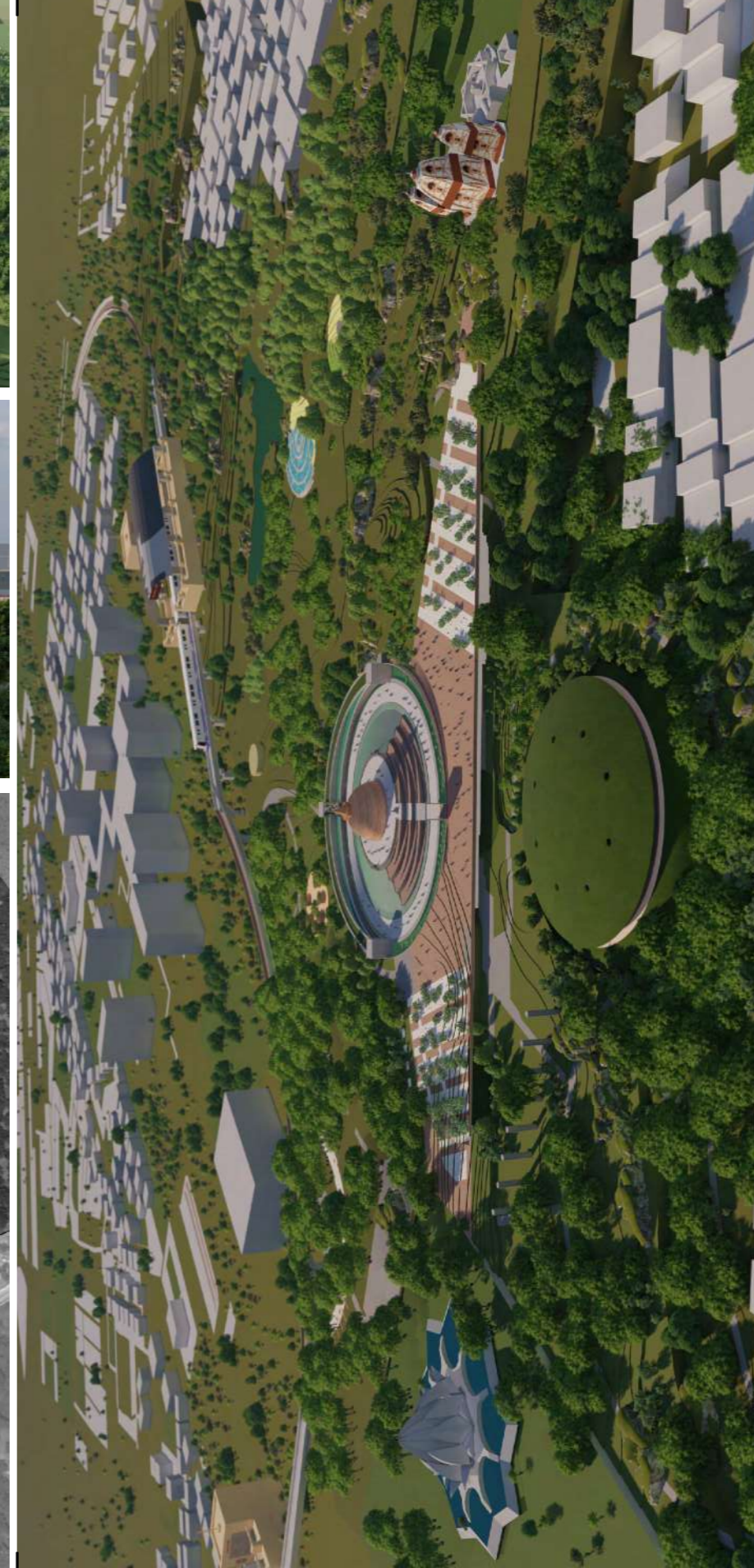

Torana

Lotus pond

Lower parikrama

Water feature

ramp

Upper parikrama

Relic stupa

Upper parikrama

Water feature

Lower parikrama

Meditation